

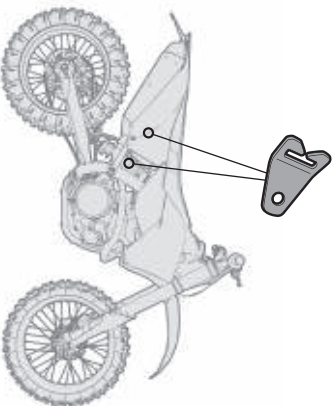

GIANT LOOP MOUNTS



Stamped and coiled stainless steel quick mounts bolt onto bike, keeping straps away from hot exhaust headers, shortening strap lengths for maximum stability and speeding installation of Giant Loop Saddlebags and Tank Bags.



Add anchor points where needed

Decide where the ideal placement is for additional anchor points. Keep them out of the way of your legs and away from the exhaust headers. You can install GL Loop Mounts virtually anywhere you can insert a bolt through the hole. Common bolt points include side panel connection to subframe and passenger peg mount points.

Passenger Peg Mounts:

Using the appropriate tool, remove the bolts for your passenger foot peg mount and replace with the GL Loop Mounts.

Use a thread adhesive on bolts to prevent them from vibrating loose.

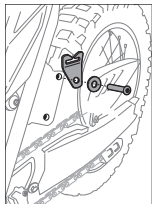
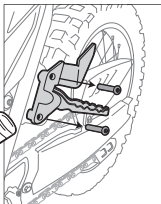

Side Panel Bolt Point:

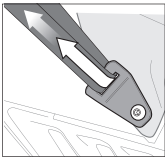
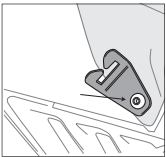
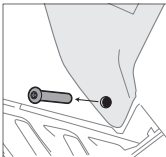

Remove bolt that secures plastic side panel to subframe. If necessary, get next longer size. We recommend using a round headed bolt to help prevent wearing pant leg or boot. Put thread lock on new bolt and torque to manufacturer's specification. **NOTE:** Mount should be positioned so webbing anchor straps pull tight in a straight line, perpendicular to the Mount slot.

NOTE: Mounts should be positioned so traps pull tight in a straight, direct line, perpendicular to the slot in the Mount, not at an angle.

Once secured, work webbing into the notch of the mount and pull secure. Extra webbing can be tied around the buckle, or cut off excess webbing and singe ends with lighter to prevent fraying.

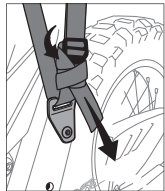
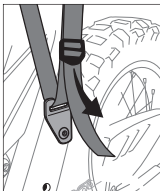
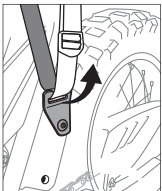

TIP: Use a round-headed bolt to prevent abrasion of pant and/or boot.